

## Ferretti Navetta 30



<b>Length:</b>	101'7 ft (30.95m)
<b>Beam:</b>	23 ft ( 7.0 m)
<b>Draft:</b>	7'5 ft ( 2.26 m)
<b>Built:</b>	2005
<b>Shipyard:</b>	CRN S.p.A. Ferretti
<b>Cabins:</b>	5
<b>Passenger Capacity:</b>	10
<b>Crew:</b>	5
<b>Speed:</b>	16.5 Knots

### Ferretti Navetta 30 Croatia

Luxury yacht charter Croatia on board Ferretti Navetta 30, latest addition to charter fleet. Superb yacht with luxury amenities and professional crew !

Built by CRN shipyard as Custom Line Ferretti Navetta, with unique stabilizer system, called : ARG' or Anti Rolling Gyro, produces a gyroscopic momentum within the vessel that reduces the rolling motion known as "Rolling Angular Velocity". By using this high tech system, known as satellite stabilization system, yacht charter Croatia, will never be the same again ! Interior : materials used are teak and marble to satisfy highest demands of any client looking to charter luxury yacht charter Croatia. Ferretti Navetta is totally different from any other Custom Line yacht, as philosophy behind her creation is the same: comfort, polish and luxury.

The VIP stateroom is the full width of the yacht and is on the main deck offering total privacy. It has a marble bath en suite with a jacuzzi tub and shower. There is another double cabin and two twins on the lower deck with en suite baths. The two twins have a Pullman berth as well. There is an additional WC on the main deck. Her salon is very large and is decorated in cream colors and warm wooden walls. There is a DVD, Video, and a giant plasma TV with satellite reception. A full audio system is here as well. Dining can be done in the dining area at the far end of the saloon or the upper aft deck or aft main deck.

The stern doors opens flat to provide a sea-level swimming platform. The sea toys are stored below aft deck in garage. Sun bathing on the upper sun deck in total privacy. One master cabin, one VIP cabin, one double-bedded cabin, two twin-bedded cabins. All cabins have an suite private facilities.

Forget rolling while on anchor or open seas. Enjoy !

### Technical Specifications :

Length: 101 ft (30.95m)

Beam: 23 ft (7.0m)

Draft: 7.5 ft (2.26m)

Built: 2005

Type : Semidisplacement Yacht

Shipyard : CRN S.p.A. Ferretti Group

Guests: 10 in 5 cabins (One master cabin. One VIP cabin. One double-bedded cabin. Two twin-bedded cabins. All cabins are an suite private facilities.)

Crew: 5

Engines & Generators: 2 x MAN V12 1360 CRM 1000@2300rpm / 2 x KOHLER 33 kW

Fuel Tank : 15'000 lt / 3'960 US gals

Water Tank : 3'000 lt / 793 US gals

Stabilizers : 3 x MITSUBISHI ARG MSM-4000

Cruising Speed: 16.5 Knots

Top Speed : 19.0 Knots

Range : 550 Nm

Operating Area: Croatia

Base Port: Marina Zadar

Electronic Equipment

Radar, GPS, Navtex, Autopilot, VHF, DCS, SAPT, EPIRB, GPRS/Email, Air condition, Water Maker, Wind Instruments, Bow-thruster

#### Entertainment

T.V. LCD Plasma 20". DVD & Hi Fi system in V.I.P.  
Master & double cabin T.V. LCD Plasma 15" , Internet

#### Amenities :

Tender AVON 490DL with Yamaha 100 HP  
2x JetSki Yamaha 1300R  
Diving Equipment

Prices indicated are per week in Euro, as all are subject to change without any notice.

Please contact our office for for guideline i.e.informations and availability

Standard Yacht Charter Option includes: Yacht rental for a week (Saturday to Saturday) Skipper, crew, use of jet boat or any other sea toys.

ALL INCLUSIVE/ Full Yacht Charter Option includes : Yacht rental for a week (Saturday to Saturday), Skipper, Stewardess that will cater for all your needs,

Breakfast, lunch and all drinks are included whilst on board, Marina fees, Fuel allowance for up to 40 nautical miles a day, Use of jet boat and watersports equipment, Fully tailored itineraries for 7 days or more, DVD and CD library for use aboard, Transfers to and from the airport.

All inclusive charter rates are not indicated! Please contact our office for additional informations about all inclusive charter prices.

## Images





Plan I palubs

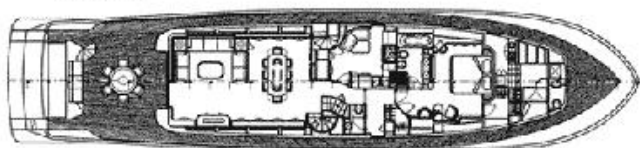

Plan potpalubis

